

---

## CITY OF KELOWNA

# MEMORANDUM

---

**Date:** November 4, 2005

**File Nos.:** Council Policy No. 258; BL9524; 6130-02)

**To:** City Manager

**From:** City Clerk

**Subject:** Dog Walking and Dog Off-Leash Parks Council Policy No. 258

**Report Prepared by:** Legislative Coordinator

---

**RECOMMENDATION:**

THAT Council approve amending Council Policy No. 258 - Dog Walking and Dog Off-Leash Parks to include adding the following:

**TEMPORARY ON-LEASH FROM NOVEMBER 1, 2005 TO APRIL 30, 2006**

- |                            |                    |
|----------------------------|--------------------|
| • City Park                | 1600 Abbott Street |
| • Kerry Park               | 1480 Mill Street   |
| • Queensway Boat Launch    | 238 Queensway      |
| • Rotary Marsh             | 1050 Sunset Drive  |
| • Stuart Park              | 1420 Water Street  |
| • Water Street Boat Launch | 1354 Water Street  |
| • Waterfront Park          | 1200 Water Street  |

AND THAT Council give reading considerations to Bylaw No. 9524 being Amendment No. 10 to City of Kelowna Parks and Public Spaces Bylaw No. 6819-91.

**BACKGROUND:**

At its regularly scheduled Council meeting on Monday, October 31<sup>st</sup>, 2005, Council approved that dogs on leash be permitted on walkways and park roads from Highway 97 through city lakefront parks to Sunset Drive on a trial basis as recommended by the Regional Dogs Advisory Committee and that the Parks and Public Spaces Bylaw No. 6819 be amended accordingly.

To reflect the amendments to allow dogs in walking parks the City Clerks staff have amended the Dog Walking and Dog Off-Leash Parks Council Policy No. 258 to identify which parks are to be added for the trial period from November 2005 to the end of April 2006. The Parks and Public Spaces Bylaw No. 6819 has been amended to include updates in Section 3.28 of the bylaw to reflect the Regional District of Central Okanagan Dog Control Bylaw. No.366.

---

A.Flack, City Clerk



# CITY OF KELOWNA

POLICY: **258**  
PAGE: 1 of 10

## COUNCIL POLICY MANUAL

APPROVAL DATE: 1998/06/22

RESOLUTION #: R529/05/05/30

REPLACING #: R520/03/06/09; R354/00/04/17; R530/99/06/21; R489/98/06/22; Policy #47 - R1111/88/07/26

DATE OF LAST REVIEW: November 2005

**“DRAFT”**

SUBJECT: DOG WALKING AND DOG OFF-LEASH PARKS

### ON-LEASH:

The following parks are identified as **dog walking parks** within which dogs on leash are permitted on trails, sidewalks, walkways and roadways in the park. Pathways and trails through children's playgrounds are excluded.

- |   |  |
|---|--|
| • Anchor Park   | 1691 Ellis Street                                |
| • Belmont Park  | 4444 Belmont Road                                |
| • Ben Lee Park  | 900 Houghton Road                                |
| • Blair Pond  | 333 Clifton Road South                           |
| • Brants Creek Linear Park                                    | Glenmore Valley                                  |
| • Calmels Park  | 1059 Calmels Crescent                            |
| • Canyon Falls Park   | 1856 Canyon Falls Court                          |
| • Chichester Wetland Park                                     | 250 Sumac Road West                              |
| • City Hall   | 1435 Water Street                                |
| • Crawford Bridle Paths Linear Park                           | Crawford Estates Subdivision                     |
| • Dilworth Mountain Park and trails                           | 2100 Chilcotin Court                             |
| • Enterprise Way Park   | 2500 Enterprise Way                              |
| • Fairhall Park   | 2448 Fairhall Road                               |
| • Fascieux Creek Park   | Richter Street and Casorso Road – <b>See Map</b> |
| • Jack Robertson Park   | 1655 Willow Crescent                             |
| • KLO Creek Regional Park                                     | 3730 Field Road                                  |
| • Knowles Park  | 865 Bernard Avenue & 888 Lawrence Avenue         |
| • Knox Mountain Park  | 540 Broadway Avenue                              |
| • Leckie Place (Brents Mill site)                             | 2135 Leckie Place                                |
| • Main Street Park (Kettle Valley)                            | 411 Providence Ave.                              |
| • Mill Creek Linear Park<br>(portions where there is a trail) | Mill Creek                                       |
| • Mission Creek Greenway                                      | From Lakeshore/Truswell to Ziprick Road          |
| • Mission Creek Regional Park                                 | 2345 Springfield Road                            |
| • Millbridge Park   | 1999 Bowes Street                                |
| • Mission Recreation Park                                     | 3975 Gordon Drive                                |
| • Mission Ridge Park  | End of Bullock Road – <b>See Map</b>             |
| • Moraine Park  | 700 Moraine Court                                |
| • Pacific Court Park  | 1955 Pacific Court                               |
| • Parkinson Recreation Centre                                 | 1800 Parkinson Way                               |
| • Quail Ridge Linear Park                                     | 2500 Quail Place                                 |
| • Redlich Park  | 1646 Gillard Drive                               |
| • Roxby Centennial Park                                       | 250 Highway 33 West                              |
| • Rutland Lions Park  | 205 Gray Road – <b>See Map</b>                   |
| • Rutland Sportsfields  | 425 Hartman Road                                 |
| • Scenic Canyon Regional Park                                 | 3801 Field Road                                  |



# CITY OF KELOWNA

POLICY: **258**  
PAGE: 2 of 10

## COUNCIL POLICY MANUAL

APPROVAL DATE: 1998/06/22  
RESOLUTION #: R529/05/05/30  
REPLACING #: R520/03/06/09; R354/00/04/17; R530/99/06/21; R489/98/06/22; Policy #47 - R1111/88/07/26  
DATE OF LAST REVIEW: November 2005

SUBJECT: DOG WALKING AND DOG OFF-LEASH PARKS

### **ON-LEASH** – Cont'd

- |                                 |                                  |
|---------------------------------|----------------------------------|
| • South Kelowna Centennial Park | 4194 Spiers Road                 |
| • Summerside Park               | 3858 Summerside Drive            |
| • Thomson Creek Linear Park     | 4105 Gordon Drive                |
| • Waste Water Treatment Plant   | 951 Raymer Road – <b>See Map</b> |
| • Wilson Creek Linear Creek     | 4186 Lakeshore Road              |
| • Winslow Park                  | 5386 Winslow Street              |
| • Wyndham Neighbourhood Park    | 131 Wyndham Court                |

### **TEMPORARY ON-LEASH FROM NOVEMBER 1, 2005 TO APRIL 30, 2006**

- |                            |                    |
|----------------------------|--------------------|
| • City Park                | 1600 Abbott Street |
| • Kerry Park               | 1480 Mill Street   |
| • Queensway Boat Launch    | 238 Queensway      |
| • Rotary Marsh             | 1050 Sunset Drive  |
| • Stuart Park              | 1420 Water Street  |
| • Water Street Boat Launch | 1354 Water Street  |
| • Waterfront Park          | 1200 Water Street  |

NOTE: Dogs are NO LONGER PERMITTED within Sutherland Bay Park

### **OFF-LEASH:**

The following parks are designated as **dog off-leash parks** within which dogs are permitted to run at large while under the control of a person capable of controlling the dog at all times:

- |                                |  |
|--------------------------------|--|
| • Glenmore Road North Dog Park | 2150 Glenmore Road North - <b>See Map</b>  |
| • Cedar Creek Park             | 5200 Lakeshore Road – <b>See Map</b>   |
| • Ellison Fields               | 4680 Old Vernon Road – <b>See Map</b>  |
| • Enterprise Way Park          | 2500 Enterprise Way  |
| • Mission Recreation Park      | West of the Mission Greenway parking lot and East of<br>Micahel brook wetland. 3975 Gordon Drive |

REASON FOR POLICY: To identify parks where owners may walk their dogs.

LEGISLATIVE AUTHORITY: Parks Regulation Bylaw No. 6819-91.

PROCEDURE FOR IMPLEMENTATION: Amendments to this policy are through the Parks Division of the Parks & Leisure Services Department.

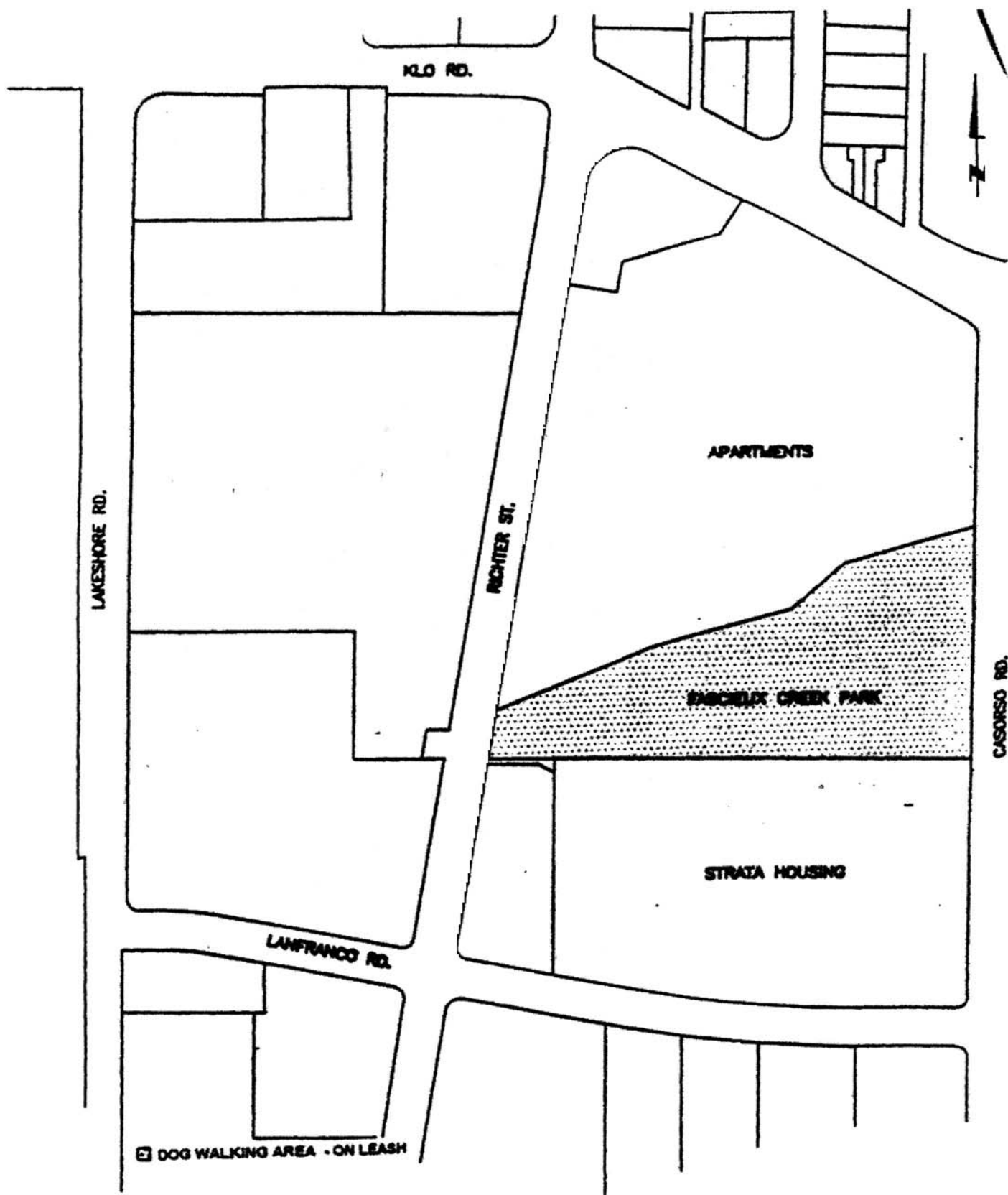

February 25, 1996

## **FASCIEUX CREEK PARK**

SCALE - 1:2500



ETHEL

RAYMER RD.

DOG WALKING AREA - ON LEASH

POLLUTION CONTROL CENTRE

DOG WALKING AREA - ON LEASH

February 25, 196

OKANAGAN COLLEGE

KLO RD.

CASORSO RD.

**KELOWNA POLLUTION CONTROL CENTRE**

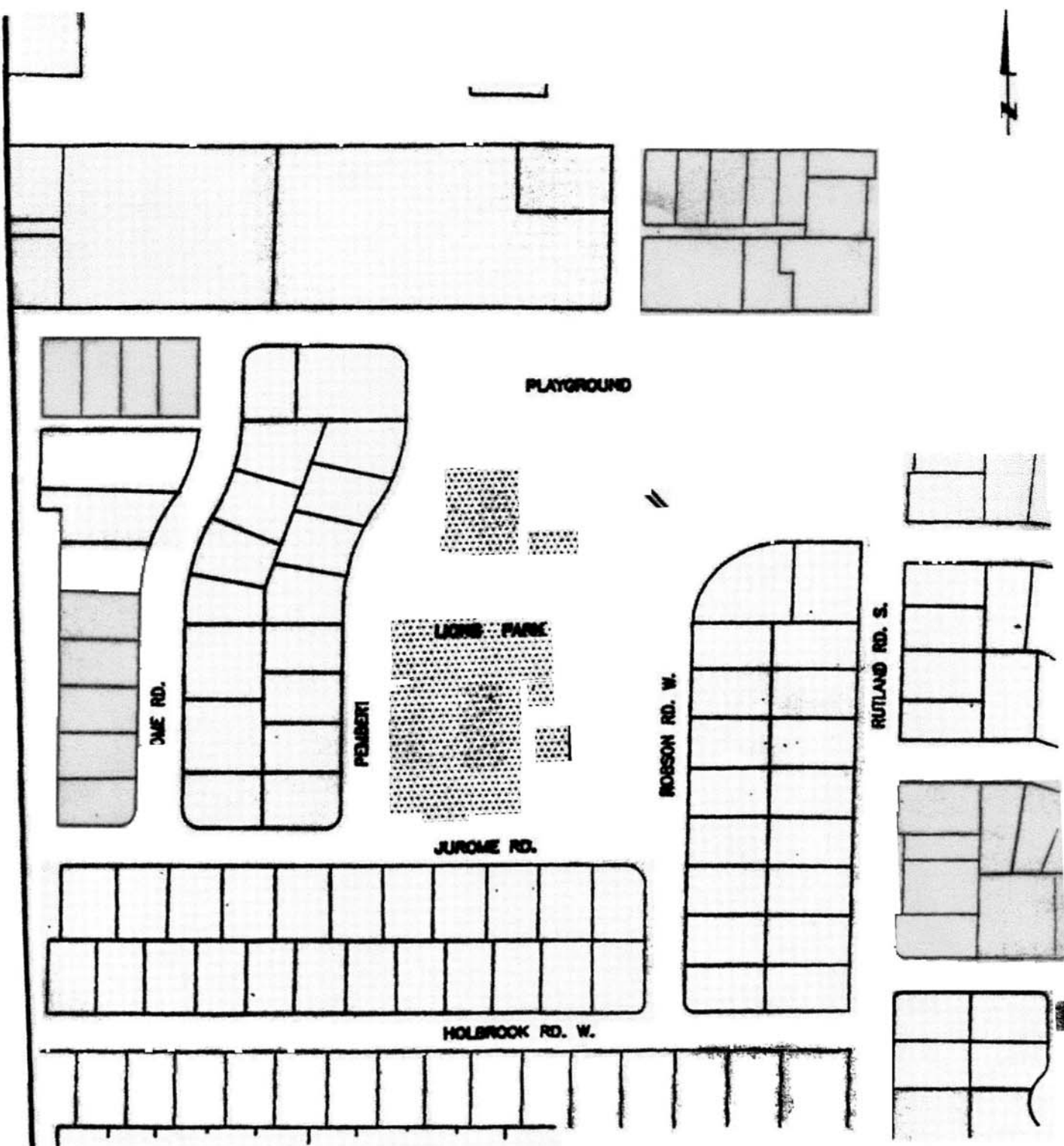

February 25, 1996

# LIONS PARK (RUTLAND)

SCALE - 1:2500



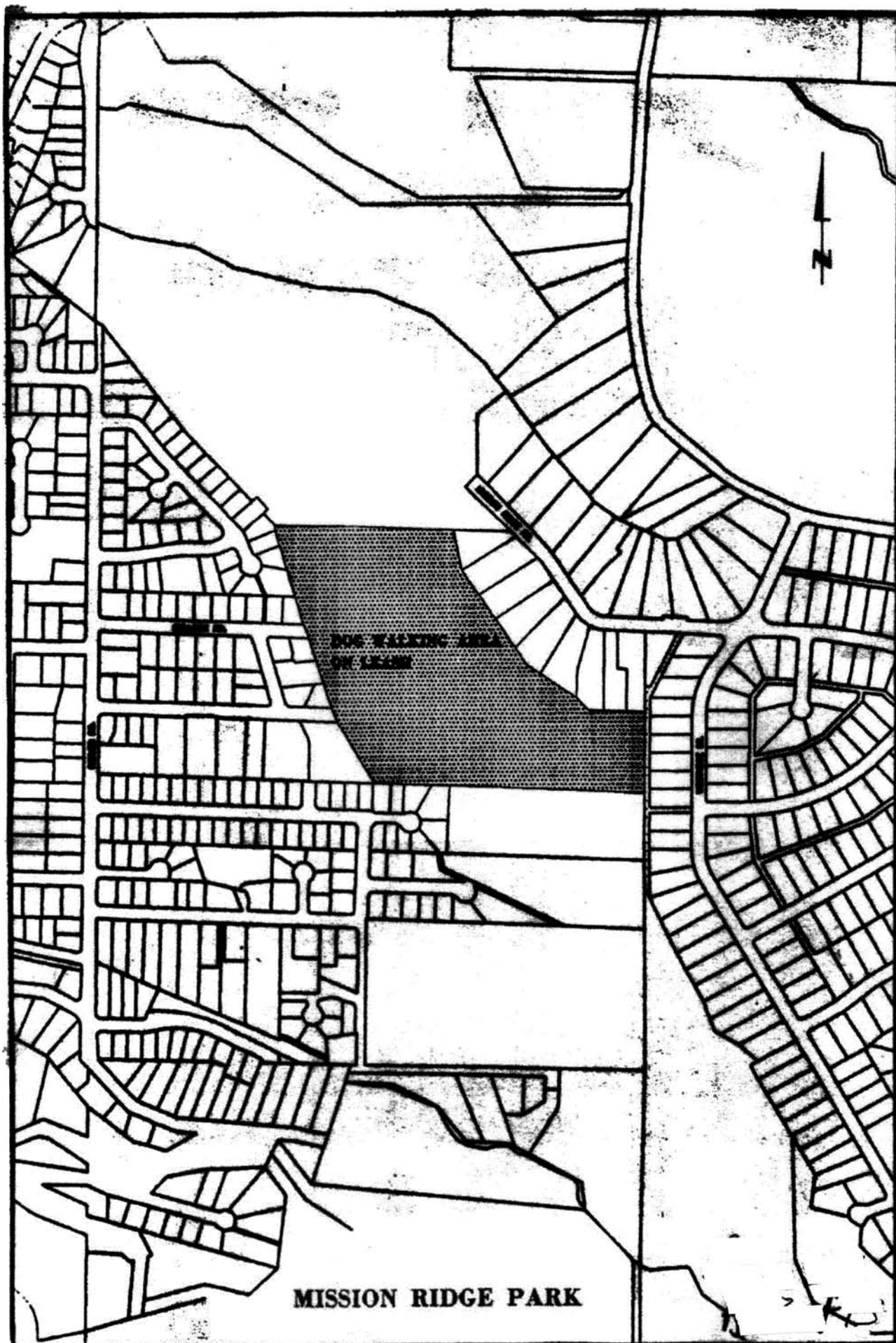



WATER

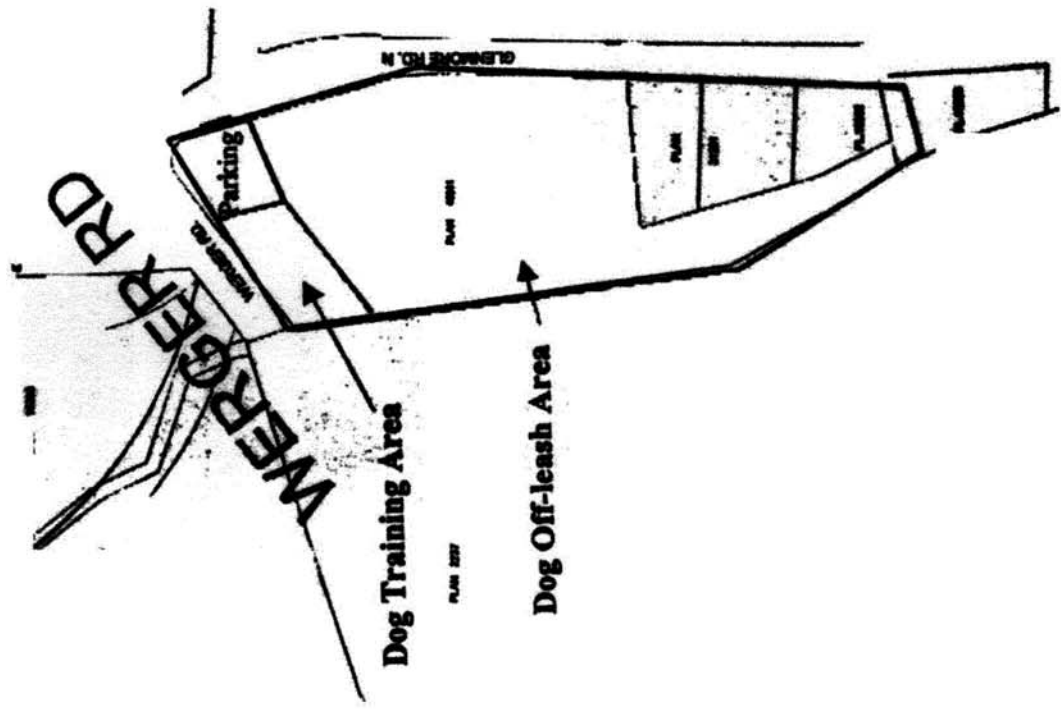

f

11

10

AREA ACROSS FROM GLEMORE ANDFILL



OKANAGAN

LAKE

CEDAR CREEK PARK

LAKESHORE RD.

 DOG WALKING AREA - OFF LEASH

February 25, 1996

**CEDAR CREEK PARK**

SCALE - 1:2500



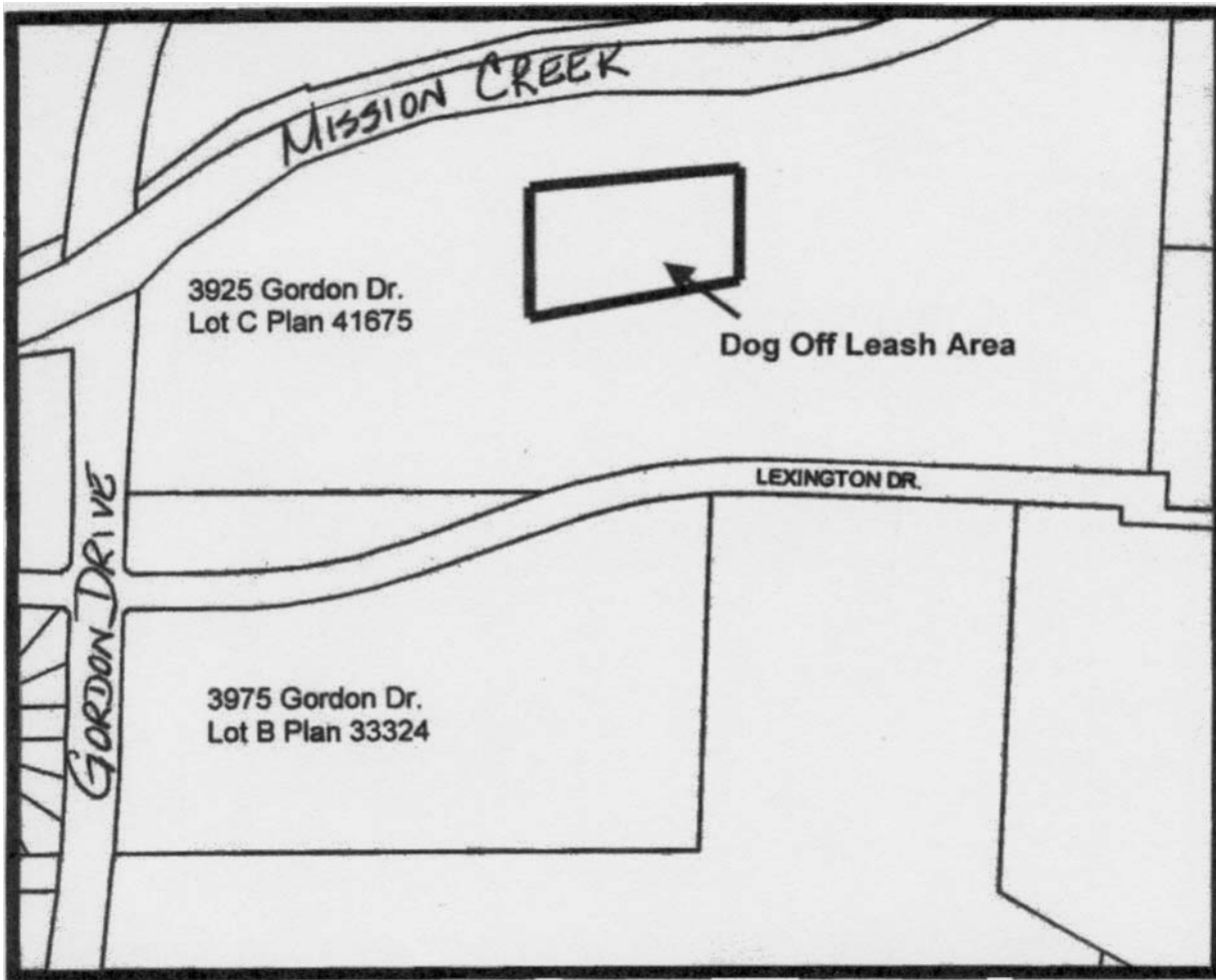

MISSION RECREATION PARK

